

Design Number SCB/MRSB 60-01
Ceiling Assemblies
Southern Cross Building Products LLC
GreenEBoard™
ASTM E 119 (2012)
CAN/ULC S 101 (2007)
NFPA 251 (2006)
UL 263 (2011)
Rating: 1 Hour
Load Applied: 790 lb/stud

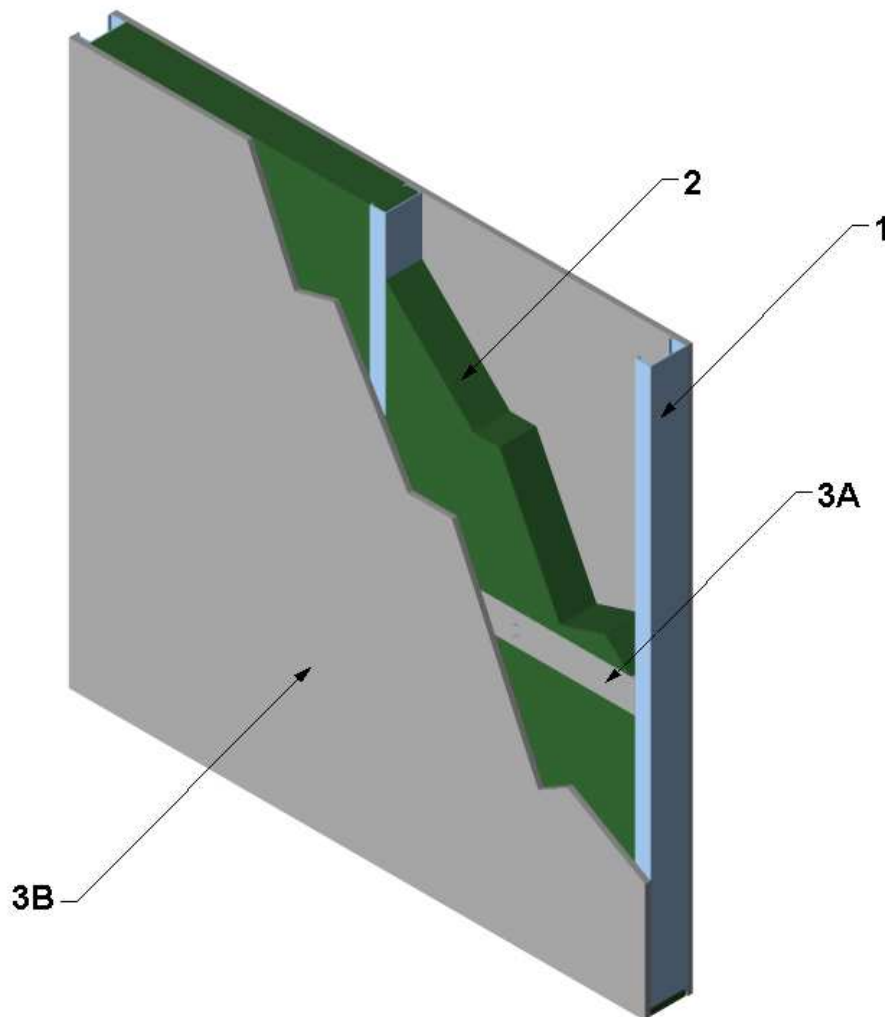

1. STEEL STUDS: Use 14 GA, 3-5/8 in. deep steel studs spaced 16 in. on center (oc). Secure steel studs to 14 GA top and bottom track using one 1/2 in. long self drilling pan head framing screw on both sides of the stud.

2. INSULATION: Install nominal 3 in. thick, 8 pcf density IIG IB 1280 mineral wool insulation between steel studs (Item 1). Cut insulation to fit between the “C” shape of the steel stud (Item 1) and compress tightly between studs.

3. CERTIFIED MANUFACTURER:
Southern Cross Building Products, LLC

CERTIFIED PRODUCT: Moisture-Resistant Sheathing Board

MODEL: GreenEBoard™

- A. BACKER STRIP: Prior to installing sheathing (Item 3B), cut 6 in. pieces of 1/2 in. thick GreenEBoard™ backer strips and install between the steel studs (Item 1) at all horizontal joints of the sheathing (Item 3B) on both sides of the wall assembly. Hold pieces in place using adhesive (Item 4) and one #6 x 1-1/4 in. long Type S bugle head self drilling screw secured through the full sheets of sheathing (Item 3B) when installed, one on the top and one on the bottom of the horizontal joints.
- B. SHEATHING: After installing backer strips (Item 3A), install one layer 4 ft. x 8 ft. sheets of 1/2 in. thick GreenEBoard™ to the interior and exterior sides of the steel studs

(Item 1) oriented vertically or horizontally. At all vertical and horizontal board joints, apply joint compound (Item 4) to completely fill the joint. Secure board using minimum #6 x 1-1/4 in. long Type S bugle head self drilling screws spaced 8 in. oc around the perimeter and 8 in. oc in the field. Offset board joints minimum 16 in. on opposing side of the wall assembly.

4. ADHESIVE (Not Shown): Apply minimum 1/4 in. diameter beads of PL 400 adhesive to the exterior side of the backer strip (Item 3A) prior to installing sheathing (Item 3B).
5. JOINT TAPE AND COMPOUND (NOT SHOWN) – Apply a level 2 finish of vinyl or casein, dry or premixed joint compound applied in two coats to all exposed fastener heads and sheathing board joints. Embed minimum 2 in. wide paper, plastic, or fiberglass tape in the layer of compound over joints in sheathing (Item 3B).